

NORTHVILLE MATTERS

CITY OF NORTHVILLE 215 WEST MAIN STREET NORTHVILLE, MICHIGAN 48167
WWW.CI.NORTHVILLE.MI.US

2013 LEAF COLLECTION SCHEDULE

FALL 2013

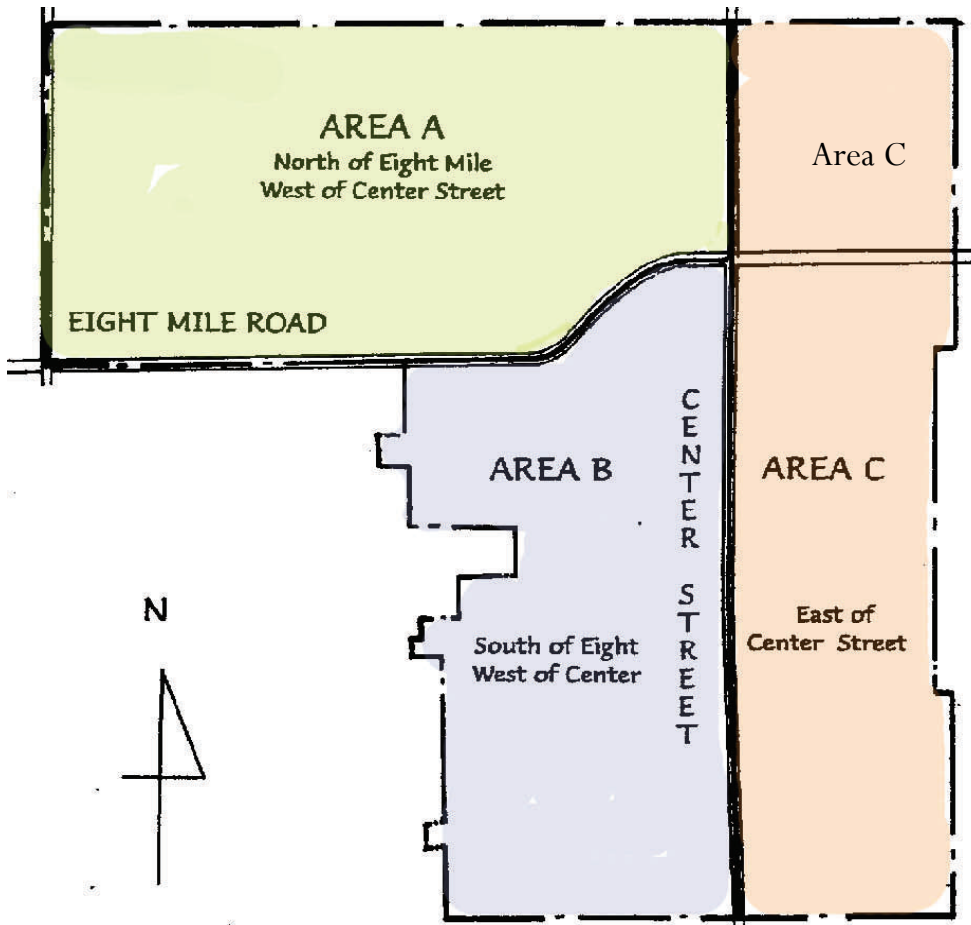

- DPW Crews will make two passes through your neighborhood this Fall.
- To prevent drainage and possible flooding problems, do not rake leaves into the street until the weekend prior to pickup.
- If you do not wish to wait until the City can collect leaves in the street, you can place your leaves in brown bags or "compost cans" which will be picked up every trash day until December 1st.
- We cannot accept leaves in plastic bags.
- Please no branches, brush, garden waste, grass clippings or trash.

Area A

Week of
October 21st
and
November 11th

Area B

Week of
October 28th
and
November 25th

Area C

Week of
November 4th
and
December 2nd

ATTENTION PRECINCT 1 (WAYNE COUNTY) VOTERS NEW POLLING LOCATION

Precinct 1 is now located at the Community Center, 303 W. Main Street. On June 29, 2013, new voter identification cards were mailed to all Precinct 1 voters to advise them of the change in polling location. Please note this change affects Precinct 1 (Wayne County) voters only.

The polling location was moved in order to provide sufficient space to accommodate voting equipment and voters on Election Day. For most elections, the precinct will be located in the gymnasium inside the Community Center. The building doors near the gymnasium will be unlocked and open for voter use on Election Day.

Precinct 2 (Oakland County) voters will continue to vote at Amerman Elementary School.

Fire Prevention Week

On Saturday, October 5th, the Fire Department will host an open house from 9:00am-4:00pm. Fire trucks and equipment will be on display and fire fighters will be on hand to talk to the kids. Fire Prevention week is October 7th –12th, the Fire Department will be open for tours from 9:00 a.m. to 4:00 p.m. each day. Bring the kids!

The “Great Escape” will be held Wednesday, October 9th. The siren will sound at 6:00 p.m. to begin the practice evacuation plan your family has in place, for information or how to create a plan, contact the Fire Department at 248-449-9920.

Explorer Cadet Fire Open House:

September 24th, 7:00-9:00pm - For ages 14-20 who are interested in exploring the career of a professional fire fighter. Come see what it's all about!

Visit <http://ci.northville.mi.us\FireExplorers>

Halloween Night

October 31st - Treats are available at the Fire Station from 6:00 p.m. until 8:00 p.m.

A Costume contest for all ages will be held at the Senior Center at 7:30 p.m. next to the Fire Station.

Trick-or-Treat Trail (Preschool-Third Grade) Sunday, October 20

Trick or Treat around Historic Mill Race Village and visit its not-so-spooky houses with your little one for this annual Halloween treat. Tickets must be pre-purchased at Parks and Recreation or online (tickets will not be sold at the event) Visit <http://northvilleparksandrec.org> or call 248-349-0203. Registration deadline is October 18th at 4:30pm

Location: Mill Race Village, 215 Griswold, Northville

Fee: \$7/Child 4:40-6:40p.m. (Timed Admission)



Halloween Trick or Treating

Trick or Treating hours in the City are on Thursday, October 31st, from 6 p.m. to 8 p.m. Several streets in historic Northville are CLOSED to traffic from 5:30 p.m. to 8:30 p.m.

- W. Main from Wing to Rogers
- W. Dunlap from Wing to Rogers
- Linden from Main to Randolph
- West from Main to Randolph
- High from Main to Randolph
- Linden Court from Linden to the end
- Dubuar from Linden to the West end
- N. Rogers from W. Main to Potomac

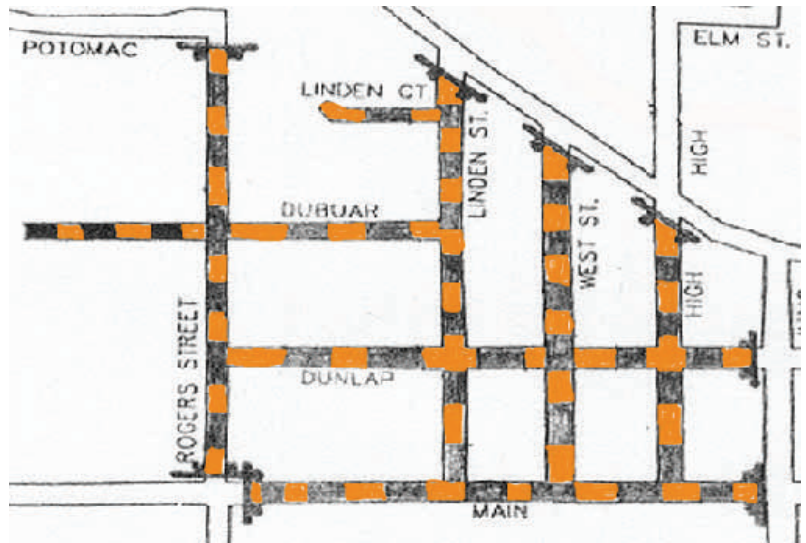

October 19, 2013 Friends of the Rouge Fall Bug Hunt

9:00am-4:00pm Join a team to search Rouge streams for insects, clams and snails to assess water quality. Pre-registration required; children welcome when accompanied by a participating adult, groups of up to 6 people. For more info: www.therouge.org

WHAT IS STORMWATER AND WHY IS IT AN ISSUE?

Stormwater is water from rain or melting snow that does not soak into the ground. It flows down slopes and roads, along ditches or from rooftops, over paved areas, across bare soil, and through sloped lawns and fields. As it flows, this runoff collects and transports pollutants such as soil, pet waste, salt, pesticides, fertilizer, oil and grease, yard waste, litter and other contaminants.

You don't need a heavy rainstorm to send pollutants rushing toward streams, wetlands and lakes—your hose can supply enough water. Even if your house is not on the waterfront storm drains or storm sewers carry runoff from your neighborhood to the nearest stream, wetland or body of water. Contrary to popular belief, most street storm drains do not carry stormwater to sewage plants for treatment. Often they flow directly into the water you enjoy for swimming and fishing.

- Polluted stormwater lowers the quality of Michigan's lakes, rivers and wetlands. Soil clouds water and degrades habitat for fish and water plants.

- Nutrients such as phosphorus and nitrogen from fertilizers and animal wastes promote the growth of algae, which crowd out other aquatic life.
- Toxic chemicals such as antifreeze and oil from leaking cars, carelessly applied pesticides, and zinc from galvanized metal gutters and downspouts threaten the health of fish and other aquatic life.
- Bacteria and parasites from pet, waterfowl and other animal waste can affect nearby inland lakes and streams.
- As many people have discovered, stormwater can be a problem closer to home, flowing into basements, where it can be difficult and hazardous to clean up.
- Stormwater can also flow down an abandoned well or poorly sealed well casing (pipe) and contaminate drinking water. There are many ways to reduce the risks posed by stormwater including stewardship practices that keep the pollutants out of stormwater as well as best management practices to reduce the amount of stormwater runoff.
<http://www.miwaterstewardship.org>

Did you know...The 5 Great Lakes - **Michigan, Superior, Huron, Erie, and Ontario contain 20% of the fresh water supply for the entire world?**

So why is stormwater so important? Do the math.....

At any one time about 97% of the total water on earth is in the oceans - not fit for human consumption. The remaining 3% is fresh water. However, 2/3 of this fresh water is frozen in polar ice caps and glaciers. This leaves only 1% fresh water available for human use worldwide.

**How Green Are you?**

Would you like to see how your routine and daily activities rate as far as "Green"?

Click on this link to see!

<http://www.miwaterstewardship.org/residents/howgreenareyou>

ABSENT VOTER BALLOT INFORMATION

AV ballots mailings will begin around September 20, 2013. Absent Voter Ballots are mailed within 24 hours after receiving your application.

The last day to request an absentee ballot by mail is Saturday, November 2nd. City Hall will be open on Saturday, November 2nd from 9 am to 2 pm for Election purposes only. The last day to vote by absentee ballot is Monday, November 4th at 4 pm. The ballot must be voted at City Hall.

Need an absent voter ballot application? Absent Voter Applications are available on the City's website at www.ci.northville.mi.us (go to: Services/City Clerk/Elections/Absentee Ballots) to print an absent voter ballot application). You may also call the Absent Voter Ballot Application Request Line at 248-449-9913. Leave the requested information and your application will be mailed.

Photo ID Required for In-Person Absent Voter Ballot Application: Effective March 27, 2013, if a voter applies to receive an absent voter ballot in person at the clerk's office, the voter is required to present a photo ID or sign the *Affidavit of Voter not in Possession of Picture Identification* form. The list of acceptable ID documents and Affidavit form are the same as those required for in-person voter registration and in-person voting on Election Day. See the Elections Section of the City's website for a complete list of acceptable photo identification documents.

ELECTION DAY INFORMATION**City of Northville Polling Locations**

Precinct 1: Community Center, 303 W. Main Street (Wayne County voters)

Precinct 2: Amerman School, 847 N. Center Street (Oakland County voters)

Polls open at 7:00 am and close promptly at 8:00 pm. You must be in line at 8:00 pm in order to vote.

Photo identification requirement in effect! Bring your current photo ID (i.e. driver's license) or be prepared to complete an affidavit that you are not in possession of your photo I.D. A ballot will not be issued unless you provide sufficient photo identification or complete the affidavit.

Not sure if you are registered to vote or which precinct you vote at? Check the Michigan Voter Information Center. Here you can verify that you are registered to vote, find your polling location, see a sample of your precinct ballot, find information on the voting equipment used in your precinct, and other helpful information. Visit our website at www.ci.northville.mi.us (go to: Services/City Clerk/Elections/Voter Registration) for a link to the Michigan Voter Information Center.

Sample ballots are available on the City's website at www.ci.northville.mi.us (go to: Services/City Clerk/Elections/Ballots)

City Directory

Allen Terrace	248-349-8030
Building Department	248-449-9902
City Manager	248-449-9905
City Clerk	248-349-1300
DDA	248-349-0345
Finance Department	248-449-9907
Fire Department	248-449-9920
Parks and Recreation	248-349-0203
Police Department	248-349-1234
Public Works	248-449-9930
Senior Community Center	248-349-4140
Tax Department	248-449-9901
Youth Assistance	248-344-1618

Frequently Used Numbers

Chamber of Commerce	248-349-7640
Civic Concern	248-344-1033
Historical Society	248-348-1845
Library	248-349-3020
Mill Race Village	248-348-1845
Waste Management	800-796-9696
Post Office	248-349-2062

Don't Flush Those Wipes

Northville, along with many other communities, are finding that baby wipes, personal wipes and flushable toilet scrubbers that are supposed to be flushable, are not. They are not breaking up when flushed as advertised and causing major blockages in sewer lines. Please only flush toilet paper down the toilet.

Recycle - bins can be purchased at City Hall for \$11.00, lids are \$6.00

