

NORTHVILLE MATTERS

CITY OF NORTHVILLE 215 WEST MAIN STREET NORTHVILLE, MICHIGAN 48167
WWW.CI.NORTHVILLE.MI.US

2014 LEAF COLLECTION SCHEDULE

FALL 2014

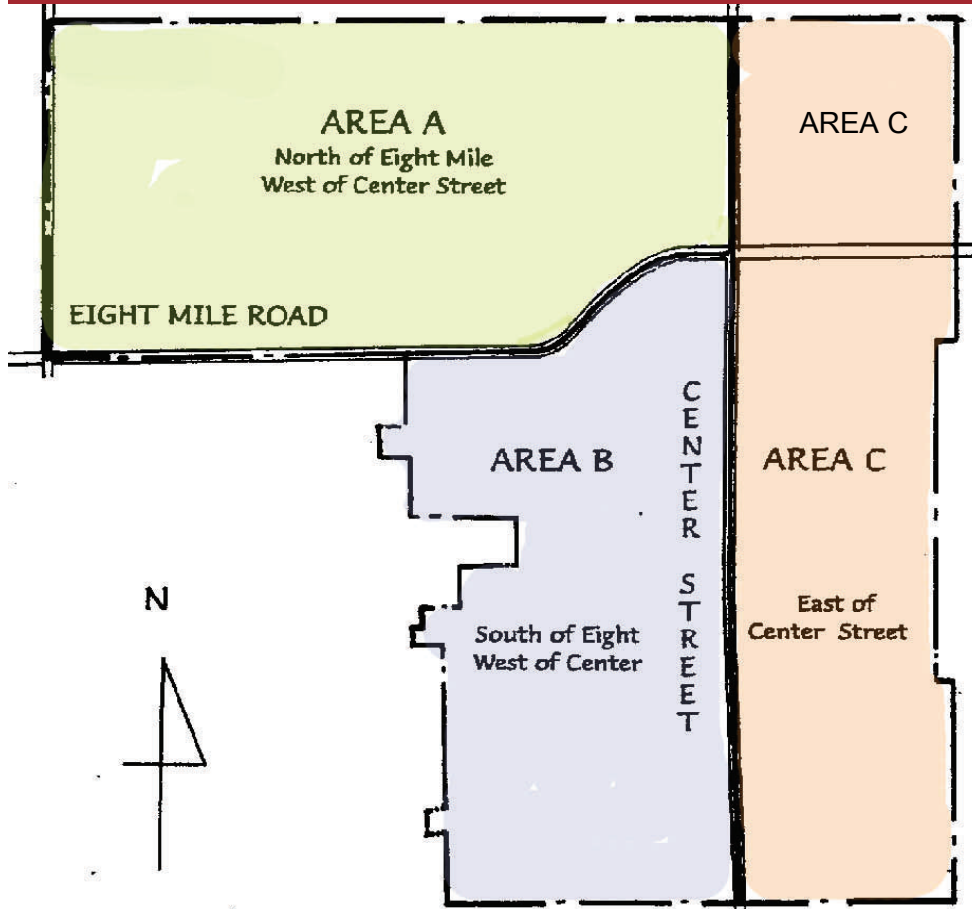

- DPW Crews will make two passes through your neighborhood this Fall.
- To prevent drainage and possible flooding problems, **do not rake leaves into the street until the week prior to pickup.**
- If you do not wish to wait until the City can collect leaves in the street, you can place your leaves in brown bags or “compost cans” which will be picked up every trash day until November 25th.
- We cannot accept leaves in plastic bags.
- Please no branches, brush, garden waste, grass clippings or trash.

Area A

Rake leaves into street before 7:00am on:

November 3rd and December 1st

Area B

Rake leaves into street before 7:00am on:

October 20th and November 10th

Area C

Rake leaves into street before 7:00am on:

October 27th and November 24th

Household Hazardous Waste Collection Event

Saturday, September 20th 8:00am—2:00pm City of Northville DPW Yard (650 Doheny Dr.)

Acceptable Items: Aerosol cans, antifreeze, household chemicals, batteries, caustic acids, computer equipment and electronics, expired medications, fluorescent light bulbs, gasoline, herbicides, pesticides, fungicides, kerosene, medical waste (sharps in containers only), mercury items, paint, stain, propane tanks, automotive fluids, varnish, turpentine. Contact DPW at 248-449-9930 with questions. Open to residents of the City of Northville, Northville Township and the City of Livonia.

ATTENTION PASSPORT APPLICANTS

The City of Northville no longer accepts passport applications. Please visit the U.S. Department of State's website www.travel.state.gov for a list of alternate passport acceptance locations.

Fire Prevention Week

The Fire Department will be open for visitors Monday October 6th through Saturday October 11th from 9:00 a.m. to 4:00 p.m. each day. Fire trucks and equipment will be on display and our Fire Department personnel will be on hand to answer questions and show visitors around. Fire prevention and public safety information will be available.

The "Great Escape" will be held Wednesday, October 8th. The siren will sound at 6:00 p.m. to begin the practice evacuation plan your family has in place, for information or how to create a plan, contact the Fire Department at 248-449-9920.

Explorer Cadet Fire Open House:

October 2nd, 7:00-9:00pm - For ages 14-20 who are interested in exploring the career of a professional fire fighter. Come see what it's all about!

Visit <http://ci.northville.mi.us\FireExplorers>

Halloween Night

October 31st - Treats are available at the Fire Station from 6:00 p.m. until 8:00 p.m.

A Costume contest for all ages will be held at the Community Center at 7:30 p.m. next to the Fire Station.

Halloween Trick or Treating

Trick or Treating hours in the City are on Friday, October 31st, from 6 p.m. to 8 p.m. Several streets in historic Northville are CLOSED to traffic from 5:30 p.m. to 8:30 p.m.

- W. Main from Wing to Rogers
- W. Dunlap from Wing to Rogers
- Linden from Main to Randolph
- West from Main to Randolph
- High from Main to Randolph
- Linden Court from Linden to the end
- Dubuar from Linden to West of Rogers
- N. Rogers from W. Main to Potomac

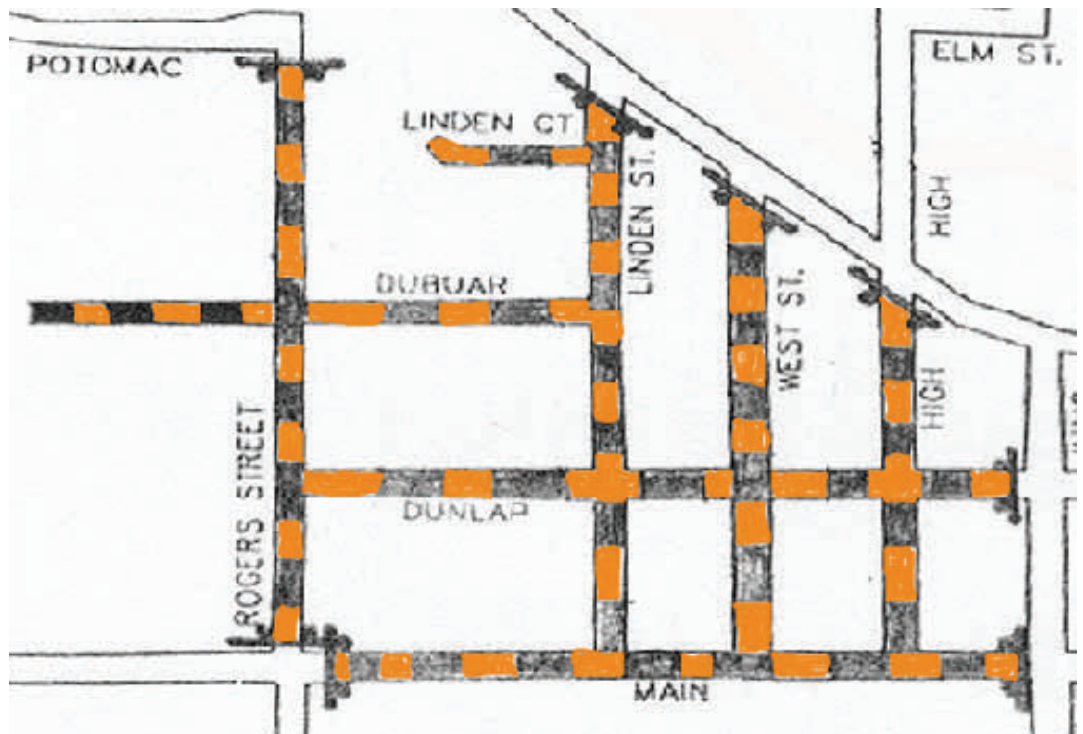

Trick-or-Treat Trail (Preschool-Third Grade) **Sunday, October 19 4:40-6:00pm**

Trick or Treat around Historic Mill Race Village and visit its not-so-spooky houses with your little one for this annual Halloween treat. Tickets must be pre-purchased at Parks and Recreation or online (tickets will not be sold at the event) Visit <http://northvilleparksandrec.org> or call 248-349-0203. Registration deadline is October 17th at 4:30pm

Attention Dog Park Members!

Dress up your little ones and bring the family dog too! In addition to treats for kids, we will have special dog friendly treats. Pre-registration is REQUIRED for this particular time (6:20pm). All dogs must be a current member of our Dog Park to register. Pet owners are required to clean up after their animals. Note: Only Dog Park members are able to register for the Doggie Trick or Treat Time. All children and animals must be registered. Please call 248-349-0203 for more info.

What is Storm Water Runoff?

One of the most significant, yet unrecognized groups of water contaminants is *storm water pollutants*. When it rains, storm water runs over yards, streets, roads, highways, parking lots, parks, and playgrounds, carrying with it everything in its path, including debris and pollutants. Eventually, the water will travel to a stream, either over land or via a storm drain. Storm drains are frequently located alongside streets and parking lots. Unlike sanitary sewers that divert water to a treatment plant directly from your home, storm drains lead directly to surrounding lakes and rivers without any type of treatment. All the debris and pollutants that were picked up by storm water runoff, end up in your lakes and streams!

Most contaminants are made up of common items used by residents, businesses and visitors, such as fertilizers, car oils and greases,

yard clippings, soil, and pet wastes.

Below are some tips you can follow to help keep pollution from entering lakes and streams via storm water runoff.

Tips to Keep Your Rivers, Lakes and Streams Clean

Never dump anything down a storm drain!

Use an oil pan when changing oil to keep fluids off the pavement. Check local body shops and quick lubes to find a place to dispose of used oil.

Bag pet waste and dispose of it in a trash can.

Leave grass clippings on your lawn as an alternate nutrient to fertilizer. If a fertilizer is necessary, choose a slow-release product and test your soil to find out

how much fertilizer your lawn actually needs.

Wash your car on your lawn so excess water, chemicals, and dirt are filtered through the lawn.

Keep household hazardous wastes, such as harsh cleaners, paint, car fluids, and batteries from entering lakes and streams by disposing at a household hazardous waste center. Try using environmentally-safe alternatives or recipes with non-hazardous ingredients.

Use a broom rather than a hose to clean up grass clippings and dirt.

Keep a trash bag in your car... and use it! For more information visit <http://www.michigan.gov/stormwatermgt>

November 4, 2014 General Election

Polls open at 7:00 a.m. and close at 8:00 p.m.

Precinct 1 (Wayne County voters) – NEW LOCATION: Northville Community Center, 303 W. Main St.

Precinct 2 (Oakland County voters): Amerman School, 847 N. Center St.

Persons offering to vote at the precinct on Election Day must show a photo id. This requirement may be satisfied by providing your current Michigan driver's license or state identification card. Voters who do not possess picture identification can vote by signing an affidavit at the polls on Election Day.

Last Day to Register to Vote: October 6, 2014

Persons registering to vote in person must show acceptable photo id or sign an affidavit.

If you choose to register to vote by mail, you may be required to vote in person for your first election. If you are a college student and you will be going away to college, consider registering to vote in person at City Hall or at any Secretary of State Branch Office.

Am I registered to vote? Where do I vote?

Visit our website at www.ci.northville.mi.us (go to: Services/City Clerk/Elections) for a link to the Michigan Voter Information Center. Here you can verify that you are registered to vote and find your polling location.

Absent Voter Ballot Information:

AV ballots mailings begin around September 20th. Once preliminary testing is complete, ballots are mailed within 24 hours after receiving your application. The office will begin issuing AV ballots over the counter beginning the week of October 20th.

Photo ID Requirement in effect for in-person Absent Voters. Voters requesting to receive their ballot in person must show acceptable photo id (i.e. current driver license). Absent Ballot voters who do not possess acceptable photo id and want to receive their ballot in person are required to complete an affidavit. Your AV ballot will be processed as a "challenged ballot."

Absent Voter Applications are available on the City's website at www.ci.northville.mi.us (go to: Services/City Clerk/Elections/Absentee Ballots).

Sample Ballots are available on the City's website at www.ci.northville.mi.us (go to: Services/City Clerk/Elections/Ballots)

City Directory

Allen Terrace	248-349-8030
Building Department	248-449-9902
City Manager	248-449-9905
City Clerk	248-349-1300
DDA	248-349-0345
Finance Department	248-449-9907
Fire Department	248-449-9920
Parks and Recreation	248-349-0203
Police Department	248-349-1234
Public Works	248-449-9930
Community Center	248-349-4140
Tax Department	248-449-9901
Youth Assistance	248-344-1618

Frequently Used Numbers

Art House	248-344-0497
Chamber of Commerce	248-349-7640
Civic Concern	248-344-1033
Historical Society	248-348-1845
Library	248-349-3020
Mill Race Village	248-348-1845
Post Office	248-349-2062
Waste Management	800-796-9696

Don't Flush Those Wipes

Northville, along with many other communities, are finding that baby wipes, personal wipes and flushable toilet scrubbers that are supposed to be flushable, are not. They are not breaking up when flushed as advertised and causing major blockages in sewer lines. Please only flush toilet paper down the toilet.

Recycling bins can be purchased at City Hall for \$11.00, lids are \$6.00

